



all rights reserved

GVWR 550kg - 1300kg

by: Piotr Goral

model year 2022

Carbontear MK I [®]

SH

SHELL



all rights reserved

GVWR 550kg - 1300kg

by: Piotr Goral

model year 2022

Carbontear MK I [®]

SH

SHELL



all rights reserved

GVWR 550kg - 1300kg

by: Piotr Goral

model year 2022

Carbontear MK I [®]

SH

SHELL



wersja bez ściany wewnętrznej



wersja ze ścianą wewnętrzną

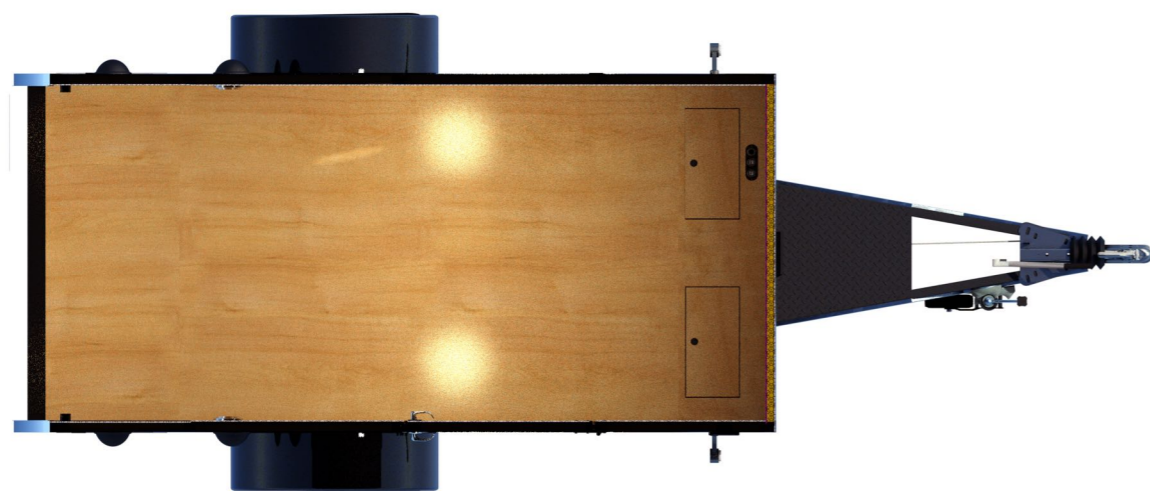

all rights reserved

dimensions

by: Piotr Goral

model year 2022

Carbontear MK I [®]

SH

SHELL

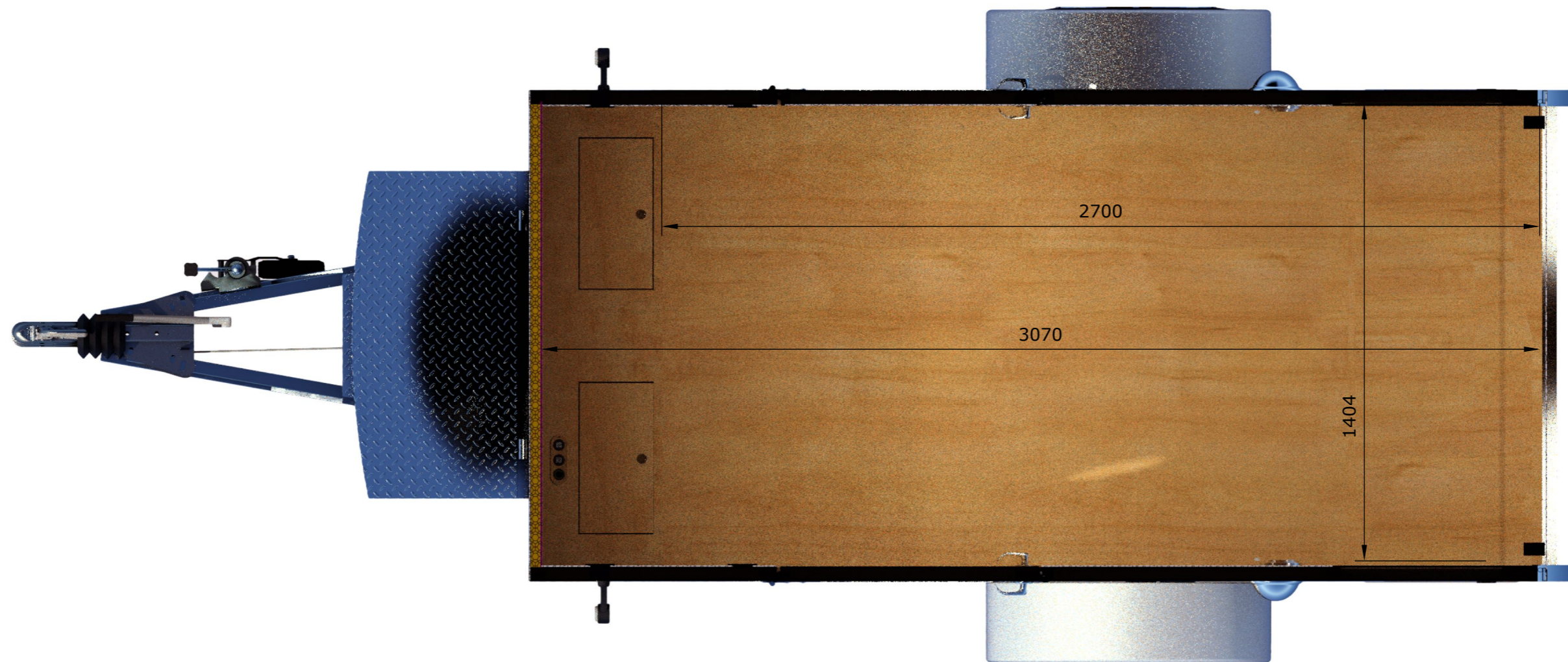

all rights reserved

space

by: Piotr Goral

model year 2022

Carbontear MK I [®]

total length - 4780 mm
 total width - 2040 mm
 total height - 2040 mm
 ride height - 400 mm

cabin length - 2040 mm
 cabin width - 1510 mm
 cabin height - 1180 mm



all rights reserved	dimensions	CarbonTear MK I [®]	SH
by: Piotr Goral	model year 2022		SHELL

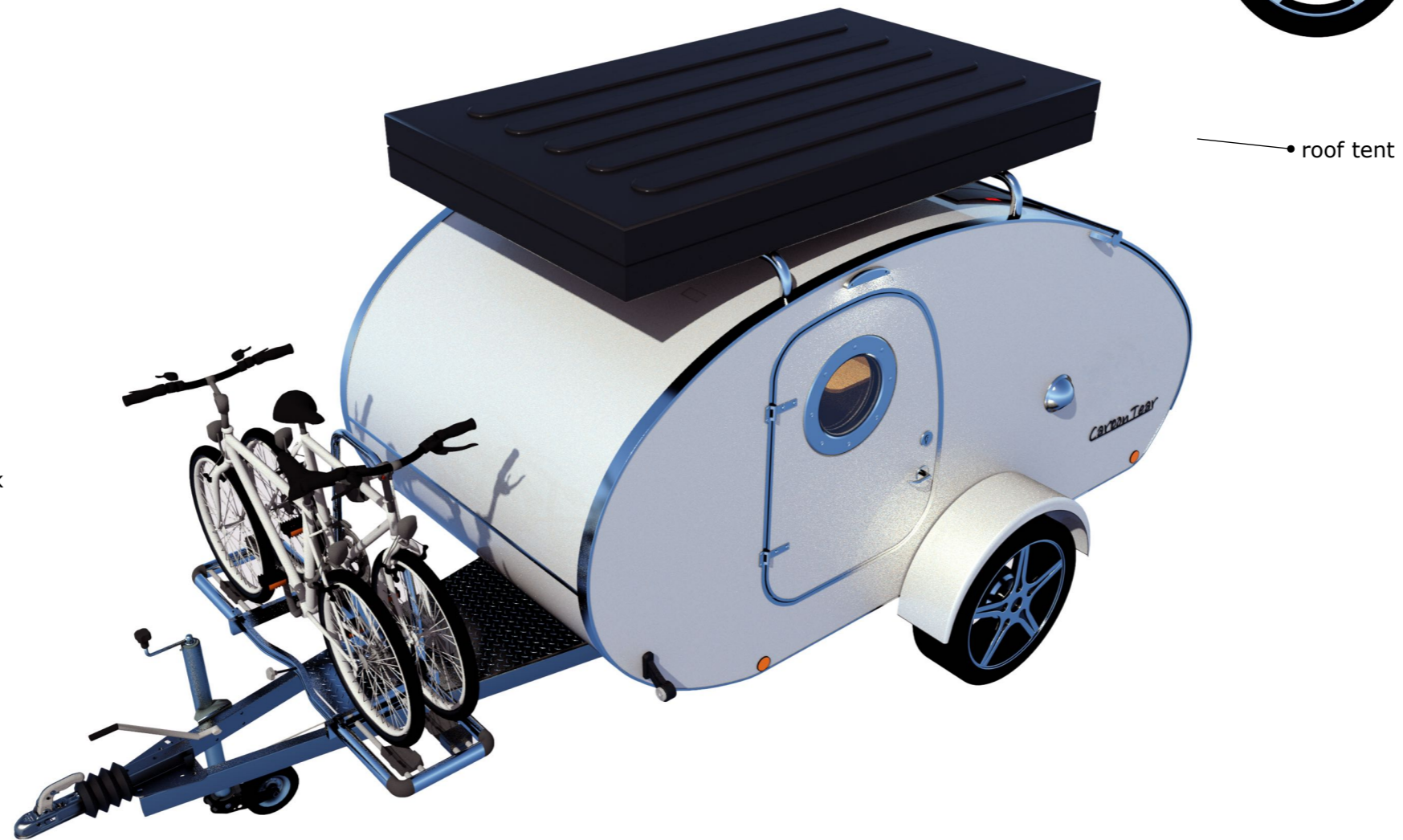
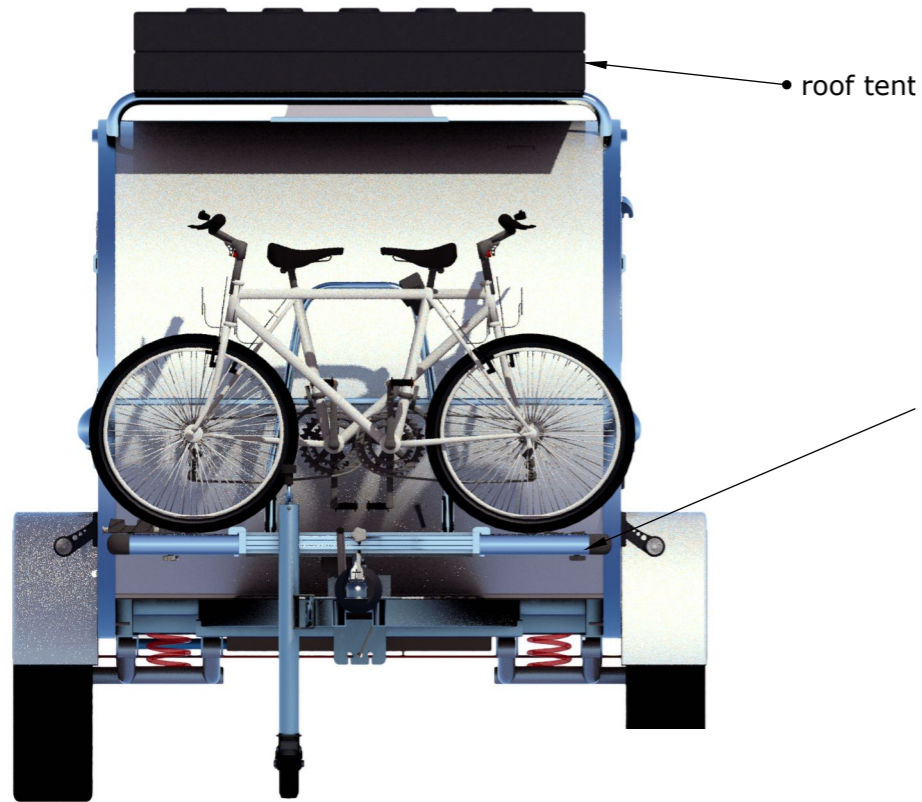

roof tent, bike rack and bicycles not included

all rights reserved	roof tent	CarbonTear MK1 [®]	ST
by: Piotr Goral	model year 2022		STREET

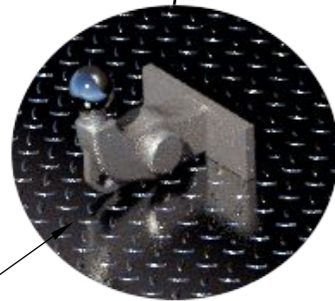

standard tow hook
for bike rack

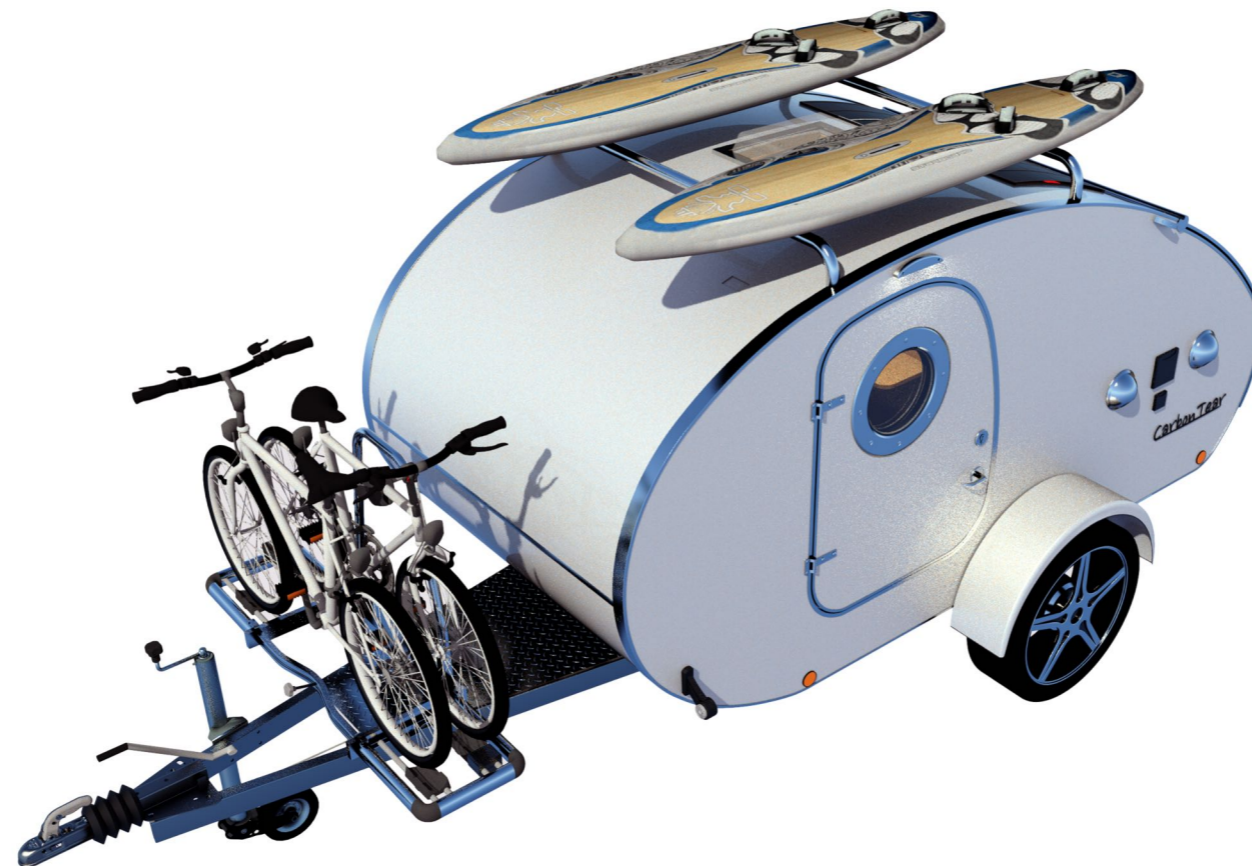

surfing, bike rack and
bicycles not included

all rights reserved

bikes and surfing

by: Piotr Goral

model year 2022

CarbonTear MK1[®]

ST

STREET



all rights reserved

body colours

by: Piotr Goral

model year 2022

Carbon[®]tear MK I

ST
STREET



all rights reserved

body colours

by: Piotr Goral

model year 2022

CarbonTear MK1[®]

SH

SHELL



oak

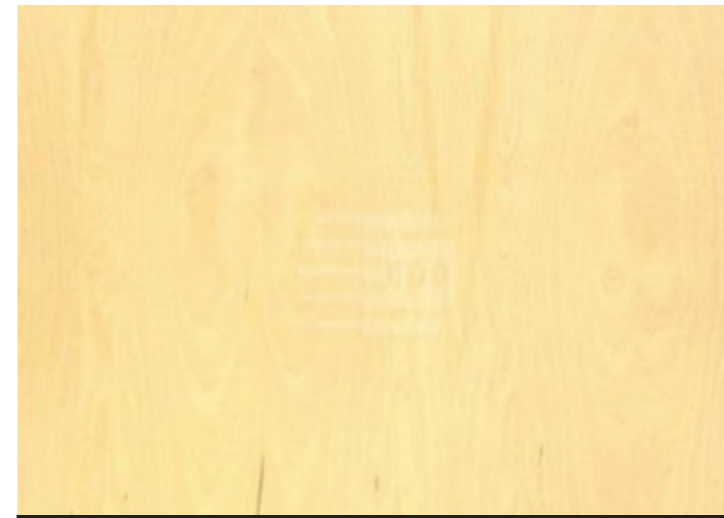

birch

all rights reserved

interior colors

by: Piotr Goral

model year 2022

Carbontear MK I [®]

SH

SHELL



Anzio Split Black



Anzio Split Polar



Anzio Split Polished



Yokohama BluEarth
All Season
215/55/R17



Pirelli Cinturato
All Season
215/55/R17



Dunlop Grandtrek
All Terrain
265/65/R17

all rights reserved

rims and tyres

by: Piotr Goral

model year 2022

Carbontear MK I [®]

SH

SHELL

Specification for SHELL:

- chassis steel covered by zink
- body construction ash wood frame
- independent suspension with brakes
- alloy rims 16 " / 17"
- supporting feet x 4
- one side door on the right
- back door
- interior finishing – oak/birch veneer
- external wall finishing wrap foil
- roof finishing wrap foil
- details, finishing stripes brushed aluminium
- led lights x 6
- interior furnishing front cupboard with oak veneer
- opening skylight 40cm / 40cm
- external 230V connector
- 50 Ah gel battery
- 12V charge socket x 2

Options:

second side door	900 Euro
composite interior finishing	400 Euro
awnings THULE OMNISTOR 260cm x 260cm	1 300 Euro
awnings DOMETIC 260cm x 260cm	800 Euro
enlarge roof widow Dometic 70cm x 50cm	350 Euro
coupling device with stabilizer	320 Euro
Carbontear roof rack	750 Euro
Carbontear roof bars	420 Euro
hook for bicycle rack on towbar	320 Euro
front box on the tow bar	480 Euro

Price in Euro excluded VAT tax 9800 Euro

loco: LUBLIN

time of manufacturing 2 months from order

all rights reserved	specification	Carbontear MK I [®]	SH
by: Piotr Goral	model year 2022		SHELL